



Smithton Primary School

RESPECT ❖ ENCOURAGE ❖ ASPIRE ❖ LEARN

DEPARTMENT OF
EDUCATION
learners first

Issue No 6

11 May 2022



2/3 Goodwin

Grade 2/3 Goodwin were straight back into learning after the holidays. We are learning about all types of shapes, their names and if they are 2D or 3D. We explored what the features are and how we see shapes all around us.

We used recyclable materials to create our own town with a focus of building and designing each structure using as many different shapes as we could. We recreated McCains, a treehouse, take away shops and houses. Some of our buildings had triangular or round windows, rectangular or square doors and included many features such as trapdoors, second stories and of course many shaped hot chips from McCains.





What a fantastic start to the term we have had here at SPS. It has been so good to see students settling back into the routines of school and enjoying being back with their friends. This term, we have some things to look forward to including Walk to School Day (20th May), National Simultaneous Story Time (25th May), School Photos (8th June) and some specialist clinics in PE among other things.

NAPLAN

This fortnight we have our Year 3 and 5 students undertaking NAPLAN testing, which is a test that is completed in all schools in Australia. The students are tested on Reading, Writing, Numeracy, Spelling, Grammar and Punctuation. The general public and the media generally make a fairly big deal about this testing, which I believe is unhelpful as it creates fear and panic for families. At Smithton Primary School, we understand that single testing of students at one point in time and on one day only gives you a small piece of information. So rather than use this data in a huge way to assess individual students, what we do is look for trends in our student's data to see if there are areas that our students struggle with, so that we can improve our teaching in these areas. It is also a good opportunity for us as a school to observe areas of strength. So please, if your child is undertaking NAPLAN, all we ask is that they do their best because that will give us the information we need to improve as a whole school.

Covid

Although we continue to have some COVID restrictions around how we run the school, it is great that as a school we can find ways to continue to feel like we are connected to one another. Some of the things to note for Term 2 in regard to COVID restrictions include:

1. **Attendance:** Students should be at school unless they are unwell or have COVID-19 symptoms. They can also stay away if they have medical advice that states they are unable to return to school due to an ongoing medical condition. They can also stay home if they have been directed by Public Health to do so.
2. **Launching into Learning (LiL):** We are now able to have LiL inside which means we can now offer two sessions (one session on Friday at 9:00am and one session on Tuesday at 11am). Mrs Melissa Coombe will be running both sessions and the details are posted on our Facebook page. To attend these sessions, come through the office area to sign in.
3. **Masks:** All staff and other adults will continue to wear masks onsite. Students in Primary School are not required to wear masks but can do if their families wish for them to do so.
4. **Assemblies:** We are not able to have Assemblies inside or outside in Term 2.
5. **Adults onsite:** We will continue to limit the number of adults onsite. However, we will be allowing pre-organised meetings and learning opportunities to start up in Term 2.

School Drop Off

We continue to ask families to do all they can to limit their time onsite at drop off times. You have all been doing a great job of this. I also would like to remind all adults to make sure you have a mask on when you are at school. We understand that it is difficult to remember (as they are not required to be worn anymore in many places), but it is a requirement that we have.

Reporting

This term we also have our first real use of a new reporting system that the Department of Education have formulated. You will read more about this in our next newsletter as we work hard to inform you on the progress your child/ren are making with their learning.

Cross Country

Finally, it is looking like Cross Country can go ahead. As a group of Principals in CH, we will make some decisions around how our Cross Country Carnivals will be ran so that all schools are consistent in the way they do Cross Country. There will be more information coming out soon.

I continue to thank families for continuing to work with us and communicating important information with us. If you ever need to discuss a question, idea, success or concern; please make a time to meet with myself or your child's teacher.

Thanks,

 **Josh Smith**
Principal

5/6 Irvine

In 5/6 Irvine, we have started our inquiry into migration. We had a brainstorm about what we already know. Some people will migrate to change their scenery or for jobs. People also migrate to live a better or happier life.

We then looked at the book *Waves* which has different stories about people's backgrounds and their migration stories. It also linked to our spelling learning about plurals.

We are excited about looking at migration around the world. We are also looking forward to discovering the main places people migrate to and from.

By Tilly Davis and Mattea Brooks

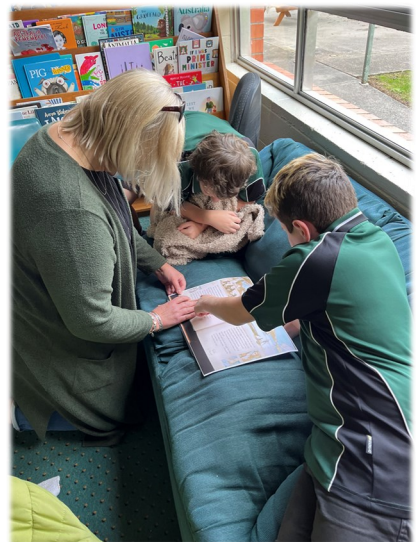



ELECTION DAY FUNDRAISER



21ST MAY
2022



8:30 AM
4:00 PM



CASH/CARD
AVAILABLE

SMITHTON PRIMARY SCHOOL

THE P&F WILL BE HOLDING AN ELECTION DAY FUNDRAISER WHICH

WILL INCLUDE:

SAUSAGE SIZZLE & SOUP

CAKE STALL (DONATIONS WOULD BE GRATEFULLY ACCEPTED)

CADBURY CHOCOLATE & KITCHEN CREATIONS COOKBOOK SALES

PLUS MEAT RAFFLE TICKETS WILL ALSO BE AVAILABLE FOR PURCHASE ON THE DAY.

CAKE STALL DONATIONS

Plate it

Please pop your items on a disposable plate and in a plastic bag and make sure it is sealed.

Label it!

To comply with health regulations please label with a list of all ingredients.

Drop it off!

Please drop off your donation to the school office on Friday the 20th before 2:30pm or Saturday 21st by 8:30am.

Thank You

Please help the P&F by baking goods for our Election day cake stall.
All donations are gratefully accepted.

• FUDGE • SLICE • MUFFINS
• BISCUITS • CAKE • TRUFFLES •
• LOAVES • JAM • RELISH •

To appeal to a variety of people, please consider packaging in several different quantities e.g:
Plate full (whole)
5-6 items
2-4 items
individual items



Student drop off and pick up

We would like to remind parents to use the Parent Carpark to drop off and collect students before and after school. Please **do not** use the Staff Carpark.

We also require students and parents to enter the school following the arrows in the diagram below. Students are **not to** walk through the staff carpark area.

When we all practice proper school parking safety, it makes it easier to keep everyone safe. Thank you for your co-operation.

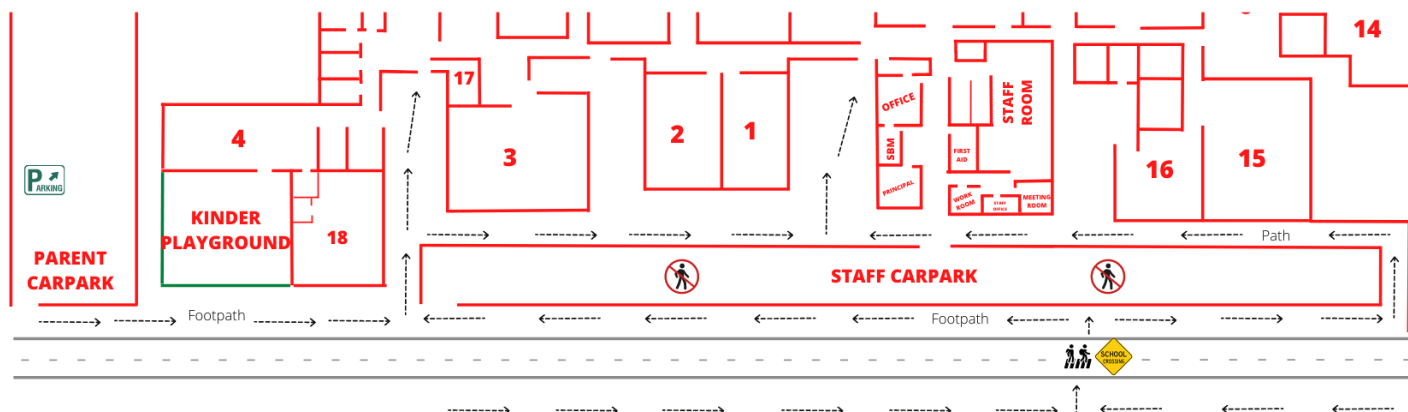

2 MAY – 8 JULY



TASMANIAN PREMIER'S

READING CHALLENGE

HAWKS



READ 10 BOOKS IN 10 WEEKS!

To find out more, visit www.premiersreadingchallenge.tas.gov.au

The challenge has started!
So grab some books and start reading!!

Department of Education 



Jhett and Lucas with our new flags

EVERY DAY COUNTS....

A day here or there doesn't seem like much, but...

When your child misses just...	that equals...	which is...
1 day each fortnight	20 days per year	4 weeks per year
1 day a week	40 days per year	8 weeks per year
2 days a week	80 days per year	16 weeks per year
3 days a week	120 days per year	24 weeks per year



Let's make every school day count

Being at school is the best place for our kids. It's where they learn and grow alongside their friends, and where they benefit the most.

The Department of Education's new communication resources on School attendance highlight the importance of regular school attendance – watch the television commercial [here](#).

Going to school not only promotes academic success, but also helps build important social skills, relationships and confidence. Every [COVID-safe measure](#) is being taken, so that every student can learn in class safely.

What we do know is that every school day counts. Bright futures begin at school, so if your child is well enough to attend school, being in the physical school environment is the best place for them.

For more information, please visit the [Department of Education website](#).

If you need support translating or interpreting this information, contact the [Translating and Interpreting Service](#) on 131 450.

Come along to join in with lots of fun, games,
activities, songs and stories

LAUNCHING INTO LEARNING

SMITHTON PRIMARY SCHOOL

For children Birth to 5 Years

LiL will be run in the Early Childhood area starting the
2nd week of Term 2.

Please enter and sign in via the school office.

Tea/coffee/milo will be provided. Please bring a hat, snack and a
drink of water for your child.

Normal Covid rules apply (including wearing of masks inside for
adults.)

*For any queries please contact the school office or the
'Early Years @ Smithton Primary School' Facebook page.*

'I look forward to meeting you and your family' - Melissa Coombe
LiL teacher



STARTING 2ND WEEK OF TERM 2



MOTHER GOOSE - TUESDAY 10TH MAY - 11AM - 12PM

LAUNCH PAD - FRIDAY 13TH MAY - 9AM - 10:00AM

THEN EVERY TUESDAY AND FRIDAY IN TERM 2



LAUNCHING
INTO LEARNING
IN TASMANIAN GOVERNMENT SCHOOLS



SAVE THE DATE
FRIDAY 20 MAY 2022
National Walk Safely to School Day

Smithton Primary School will
be

participating in

**WALK SAFELY TO SCHOOL
DAY**

On Friday 20th May, stay
tuned for more details.

**ACTIVE KIDS ARE
SMARTER KIDS**



FRIDAY 20 MAY 2022

Until they're ten, children must always hold
an adult's hand when crossing the road

WALK.COM.AU

[@smithtonprimaryschool](https://www.facebook.com/smithtonprimaryschool) [@smithtonprimaryschool](https://www.instagram.com/smithtonprimaryschool) [@smithtonprimaryschool](https://www.tiktok.com/@smithtonprimaryschool) #WSTSD
SUPPORTED BY THE AUSTRALIAN GOVERNMENT AND ALL STATE, TERRITORY AND LOCAL GOVERNMENTS

SMITHTON PRIMARY SCHOOL

Parents & Friends Cadbury Fundraiser



Contains a mix of:



**LARGE
SIZE**

Large Freddo & Caramello Koalas \$1ea

BUY A BOX FOR \$60

Contact Rhiannon Powell or email
parentsandfriends.sps@gmail.com
if you are interested in either purchasing or selling a box.
Thank you for your support

**\$5 PER
TICKET**

SMITHTON PRIMARY SCHOOL

★ P&F RAFFLE ★



MAJOR PRIZE :

**CHEST FREEZER WITH
\$700 WORTH OF MEAT**



**PLUS OTHER VARIOUS VALUED PRIZE BEEF
MEAT PACKS ARE UP FOR GRABS.
DRAWN 26TH MAY**

Managing COVID-19 in schools

This term, there will be some changes in how COVID-19 cases are managed in schools.

Our school will continue to work closely with Public Health to safely manage any COVID-19 cases, with a focus on testing students and staff who have symptoms.

The number of students and staff with COVID-19 will be closely monitored, and we will work with Public Health to respond as needed. If there's an increase in cases, Public Health will tell us what we need to do and what actions families will need to take.

Parents and carers will no longer receive a message every time there is an individual case in a class or grade – unless students or staff are medically vulnerable.

If you have any questions or concerns, please contact our school office.

For more information about COVID-19, please visit the [Tasmanian Government Coronavirus website](#) or contact the [Tasmanian Public Health Hotline](#) on 1800 671 738, or Department of Education COVID-19 Support Hotline at COVID19support@education.tas.gov.au or on 1800 816 057.

If you need support translating or interpreting this information, contact the [Translating and Interpreting Service](#) on 131 450.

Changes to close contact requirements

Public Health has recently changed the rules for close contacts of COVID-19 cases so that they no longer need to isolate.

This means that if your child is a close contact – and importantly, symptom-free – they can attend school (except for support schools).

They would however need to pass a daily rapid antigen test before leaving home each day, for a seven-day period. Advice for close contacts is available on the [Tasmanian Government Coronavirus website](#).

You will only need to let us know if your child is a close contact if they're **not attending** school.

Close contacts should practise COVID-safe behaviours including good hand hygiene, physically distancing from others when they can and staying away from school if they have any symptoms.

While primary aged close contacts are not obliged to wear a mask in school, they can still choose to if it is practicable for them and they are happy to do so.

If your child is medically vulnerable and you have concerns with the changes to close contacts, then you may wish to work with your child's medical practitioner to identify further options to reduce the risk of COVID-19 to them. If you have any concerns, please talk to us about alternative learning options.

If you have any questions or concerns, please contact our school office.

For more information about COVID-19, please visit the [Tasmanian Government Coronavirus website](#) or contact the [Tasmanian Public Health Hotline](#) on 1800 671 738, or Department of Education COVID-19 Support Hotline at COVID19support@education.tas.gov.au or on 1800 816 057.

If you need support translating or interpreting this information, contact the [Translating and Interpreting Service](#) on 131 450.

Dates To Remember

May

Every Tuesday - 11:00am - 12pm	Mother Goose - Birth to 5 Years
Every Friday - 9:00am to 10:00am	Launch Pad - Birth to 5 Years
Friday 20th	Walk to School Day

June

Every Tuesday - 11:00am - 12pm	Mother Goose - Birth to 5 Years
Every Friday - 9:00am to 10:00am	Launch Pad - Birth to 5 Years
Wednesday 8th	School Photo Day
Monday 13th	Public Holiday - Queen's Birthday
Friday 6th	Public Holiday - Agfest

July

Tuesday 5th - 11:00am - 12pm	Mother Goose - Birth to 5 Years
Friday 8th - 9:00am to 10:00am	Launch Pad - Birth to 5 Years
Friday 8th	Last day of term for students
Monday 25th	Staff Professional Learning Day
Tuesday 26th	Term 3 begins for students



String Lessons

Learn to play a stringed instrument

Violin Viola Cello

My name is Helen Hurst and I have taught for 30 years. I have recently moved from Queensland where I ran several award-winning string programs.

The cost of a 30-minute lesson is \$30. Students may attend individually, or in small groups of up to four students (the cost is shared across the group making the cost less per student).

Students will need to supply their own instrument.

To register your interest please email helenhurst@hotmail.com



2022 School Term Dates

Term 1	Wednesday 9th February to Wednesday 13th April
Term 2	Monday 2nd May to Friday 8th July
Term 3	Tuesday 26th July to Friday 30th September
Term 4	Monday 17th October to Wednesday 21st December

CONTACT DETAILS

27-43 Grant Street, Smithton, Tasmania 7330

Phone: 03 6452 1955

Email: smithton.primary@education.tas.gov.au

Web: smithtonprimary.education.tas.edu.au

